

043461

LARAMIE COUNTY
WY.

CERTIFIED LAND CORNER RECORDATION

1988 MAY 5 PM 1 27

DESCRIPTION OF CORNER EVIDENCE FOUND, AND ORIGINAL RECORD (If known)
Found 16" x 12" x 8" limestone with no markings.

S.32 S.33
S.5 S.4
T.14N. R.64W.
T.13N.
6th P.M.

G.L.O. Record - Limestone 16" x 12" 8" - John B. Thomas, Deputy Surveyor,
17 October, 1870.

DESCRIPTION OF MONUMENT AND ACCESSORIES ESTABLISHED
TO PERPETUATE THE ORIGINAL LOCATION OF THIS CORNER:

At the corner: Set 2 1/2" x 30" aluminum pipe with 3" aluminum cap projecting 6" above ground
stamped as shown below and buried stone on West side.

Accessories : See ties below.

SKETCH, WITH COURSE AND DISTANCE TO ADJACENT CORNER IF DETERMINED IN THIS SURVEY.
(May Sketch or Paste Reproduction on Reverse Side.)

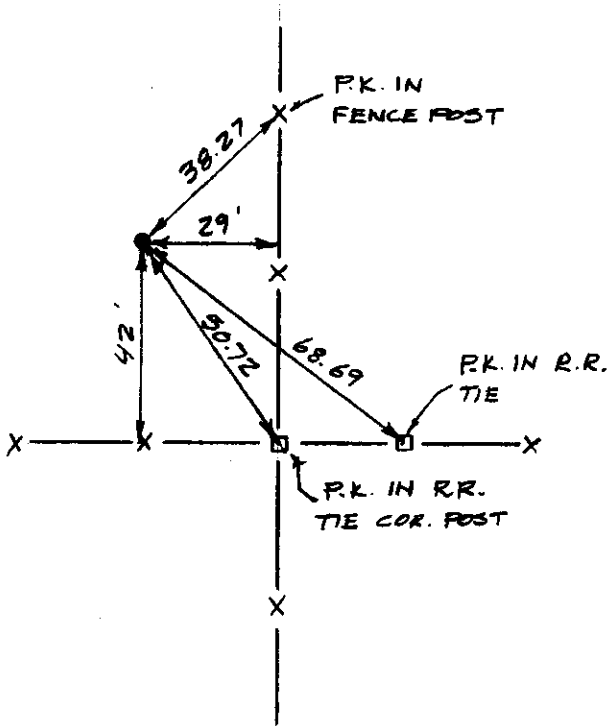

I, John A. Steil certify that I have carefully performed or reviewed the work
done on the diagrammed corner as reported on this recordation form and approve the same.

John A. Steil
Signature of Surveyor

L.S. 2500
Registration No.

STATE OF WYOMING,
Office of Clerk and Recorder,
County of Laramie

This "corner record" was filed for record on the 5th day of May, 1988, was noted
on the cross-index plat and is assigned page No. 1977, in book No. 1259

Janet C. Whitehead
County Official

Cross Index No.	A-9	T. 13N	R. 64W	Mer. 6th
	Z-9	T. 14N	R. 64W	Mer. 6th
		T. _____	R. _____	Mer. _____
		T. _____	R. _____	Mer. _____
		T. _____	R. _____	Mer. _____
		T. _____	R. _____	Mer. _____
		T. _____	R. _____	Mer. _____

BOOK 1259

1977